

SK3- II

Wireless Access Control

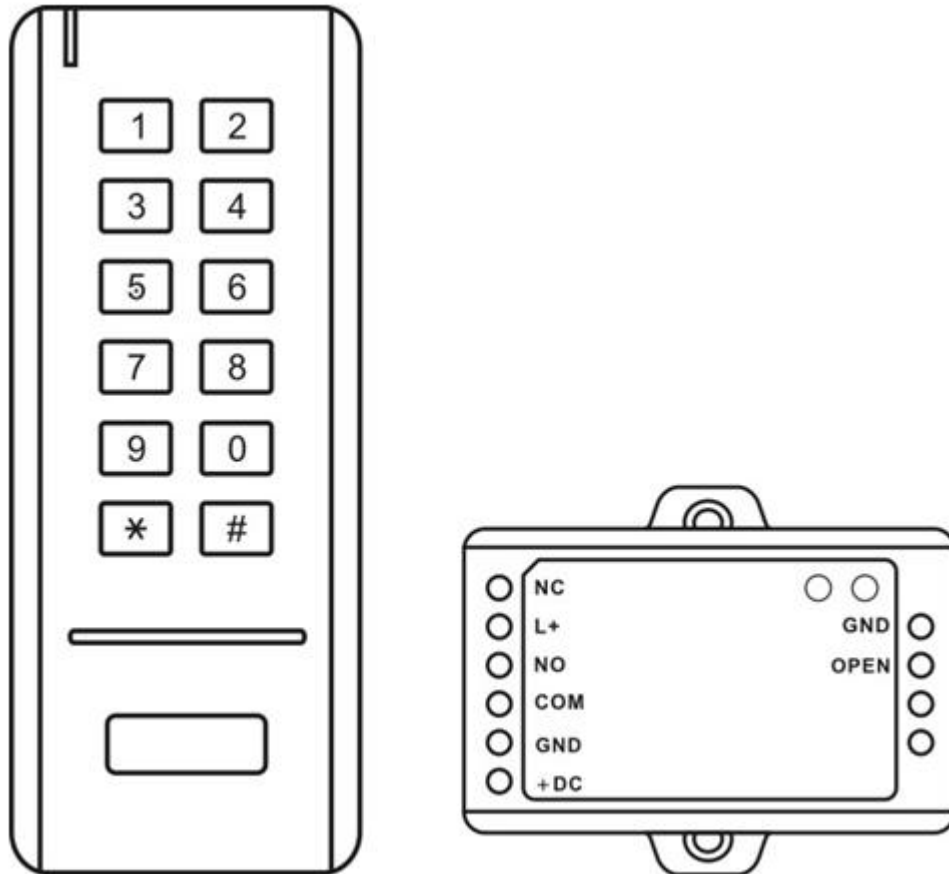

User Manual

INTRODUCTION

The SK3- II is a single door wireless access control, consists of a wireless keypad, a mini controller and a wireless exit button. TEA + Rolling Code of encryption algorithm and the split design guarantees higher-secure.

The keypad can store 500 PIN / card users. Because of ultra low power consumption, the keypad and the exit button can work as long as one year (bases on 30 times/day), with just 3 units of AAA batteries and 1 unit Li-battery. It will remind people to replace batteries intelligently if low battery.

Features

- 500 PIN / card users
- PIN length: 4~8 digits
- 125KHz EM card
- Communication frequency: 2.4G
- Communication distance: 15m Max
- Pulse mode, toggle mode
- Tri-color LED status display
- Ultra low power consumption (wireless keypad≤10uA, Wireless Exit Button: ≤6uA)

Specifications

User Capacity PIN Length Card Type	500 4~8 Digits 125KHz EM Card
Operating Voltage Wireless Keypad Mini Controller	3units of AAA batteries 12V DC ±20%
Current Idle Current Working Current	Wireless Keypad: ≤10uA Mini Controller: ≤20uA Wireless Keypad: ≤50mA; Mini Controller: ≤40mA
Communication Frequency	2.4G
Communication Distance	15m Maximum
Relay Contact Load	2Amp Maximum
Environment Operating Temperature Operating Humidity	Indoor -20°C~60°C (-4°F~140°F) 0%~86%RH
Physical Dimensions Unit Weight Shipping Weight	ABS Shell Wireless Keypad: L135 × W54 × D19(mm) Mini Controller: L65 × W54 × D19(mm) Wireless Keypad: 90g Mini Controller: 40g 250g

Carton Inventory



Wireless Keypad

Mini Controller

L135 × W54 × D19 (mm)

L65 × W54 × D19 (mm)



Diode IN4004 (For relay circuit protection)

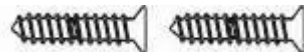

Self Tapping Screws: Φ3*25mm

Self Tapping Screws: Φ4*25mm



Wall Anchors



Screw Driver

Screw Driver

INSTALLATION

Method 1: Stick by 3M stickers

The device packed with 3M double-side Sticker, can easily stick the Wireless Keypad and Mini Controller on Metal door, Glass Door, Wooden Door, or Smooth Wall.

Method 2: Install by screws

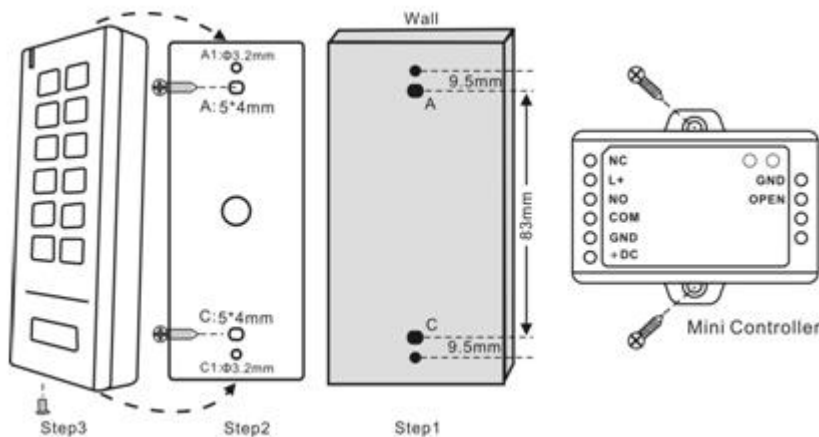

Sound and Light Indication

Operation Status	Red LED	Green LED	Buzzer
Standby	-	-	-

Unlock the lock	-	ON for 3 seconds	One beep
Key press under Program Mode	-	-	One beep
Enter into Program Mode	Shines per 1.5 seconds	-	One long beep
Invalid PIN	-	-	-
Exit from the Program Mode	-	-	One beep
Low battery reminding (Keypad)	Orange LED ON		Three beeps
Low battery reminding (Exit button)	Shines from Red to Green twice		-

Connection Diagram

Access Control Power Supply:

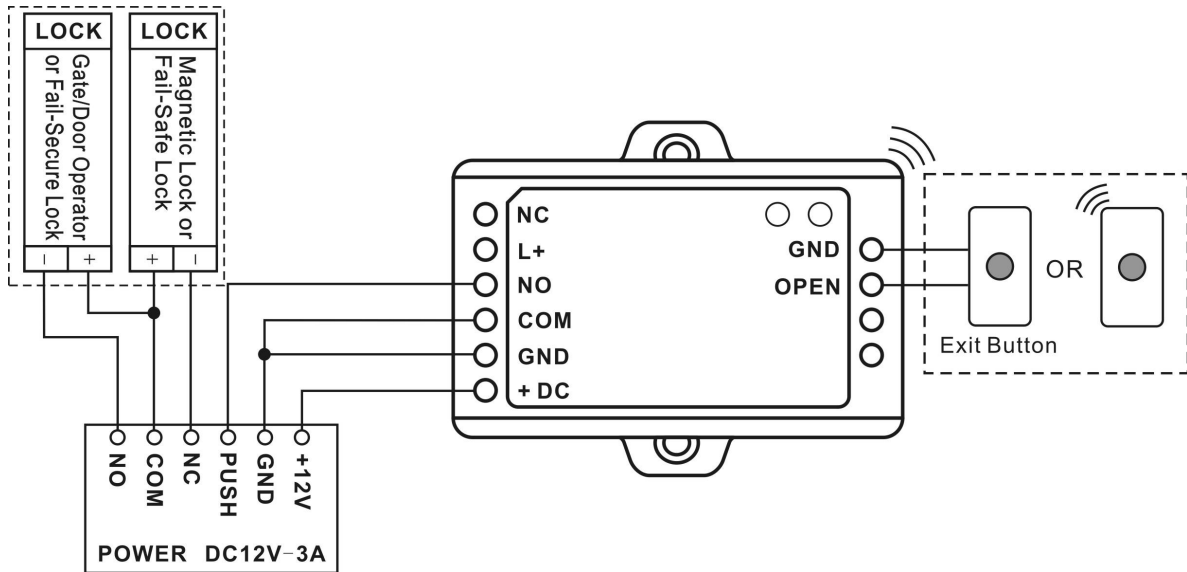

Common Power Supply:

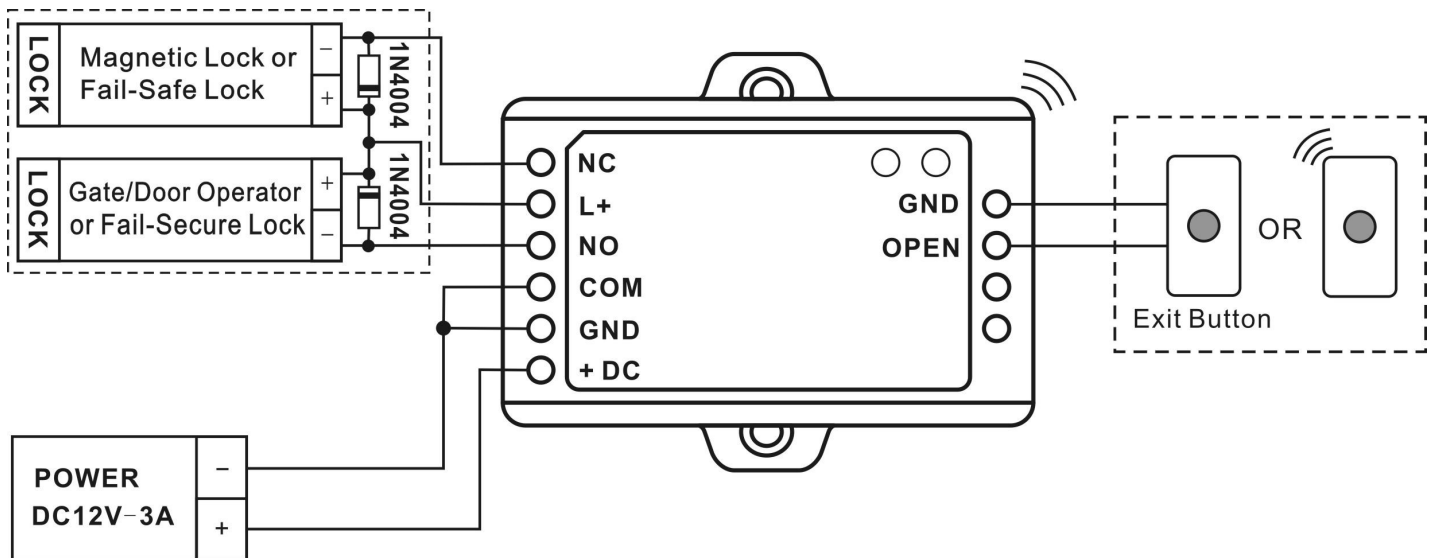

PROGRAMMING

Enter and Exit Program Mode

Programming Step	Keystroke Combination
------------------	-----------------------

1. Enter Program Mode	* (Master Code) # (Factory default is 123456)
2. Exit	*

Set Master Code

Programming Step	Keystroke Combination
1. Enter Program Mode	* (Master Code) #
2. Update Master Code	0 (New Master Code) # (Repeat New Master Code) # Master code is any 6 digits
3. Exit	*

Add User PIN(s)

User ID: 0~499

PIN length: 4~8 digits

Programming Step	Keystroke Combination
1. Enter Program Mode	* (Master Code) #
2. Add PIN	1 (User ID) # (PIN) # (Repeat PIN) # The PINs can be added continuously
3. Exit	*

Add User Card(s)

User ID: 0~499

Card type: 125 KHz EM card

Programming Step	Keystroke Combination
1. Enter Program Mode	* (Master Code) #
2. Add Card: Using Auto ID (Allows SK3- II to assign Card to next available User ID number) OR 2. Add Card: Select Specific ID (Allows Master to define a specific User ID to associate the card to)	1 (Read Card) # The cards can be added continuously. 1 (User ID) # (Read Card) #
3. Exit	*

Change PIN Users

Programming Step	Keystroke Combination
Note: Below is done outside programming mode, users can undertake this themselves	
2. Change PIN: By Card (There will auto allocate PIN(8888) to cards when adding)	* (Read Card) (Old PIN) # (New PIN) # (Repeat New PIN) #
2. Change PIN: By PIN	* (User ID) # (Old PIN) # (New PIN) # (Repeat New PIN) #
3. Exit	Exit automatically

Delete Users

Programming Step	Keystroke Combination
1. Enter Program Mode	* (Master Code) #
2. Delete user OR 2. Delete Card OR 2. Delete all users	2 (User ID) # The users can be deleted continuously 2 (Read Card) # 2 (Master Code) #
3. Exit	*

Set Access Mode

Programming Step	Keystroke Combination
1. Enter Program Mode	* (Master Code) #
2. PIN Access OR PIN + Card Access OR PIN or Card Access	3 0 # 3 1 # 3 2 # (factory default)
3. Exit	*

Set Relay Configuration

The relay configuration sets the behavior of the output relay on activation.

Programming Step	Keystroke Combination
1. Enter Program Mode	* (Master Code) #
2. Pulse Mode OR 2. Toggle Mode	4 (1-99) # (factory default) The relay time is 1-99 seconds. (1 is 50mS.) (Default is 5 seconds) 4 0 # Set the relay to ON/OFF Toggle mode
3. Exit	*

Set Safety Mode

In safety mode, it can be set to deny access for 10 minutes after 10 failed PIN/card attempts in 10 minutes (Factory default is OFF).

Programming Step	Keystroke Combination
1. Enter Program Mode	* (Master Code) #
2. Strike-Out OFF OR 2. Strike-Out ON	6 0 # (factory default) 6 1 #
3. Exit	*

Set Buzzer

Programming Step	Keystroke Combination
1. Enter Program Mode	* (Master Code) #

2. Buzzer OFF OR 2. Buzzer ON	7 0 # 7 1 # (factory default)
3. Exit	*

OTHERS

Users Operation

Programming Step	Keystroke Combination
PIN User Access	(PIN) #
Card User Access	# (Read Card)
PIN + Card User Access	# (Read Card) (PIN) #

Pair Wireless Keypad / Exit Button and Mini Controller

- 1) They all are already paired when out of factory, if no problem, the users do not need to do this operation in using.
- 2) One Mini Controller can be connected by **five** pcs of Wireless Keypad and Exit Button maximum.

To pair the Wireless Keypad and Mini Controller:

Wireless Keypad: * Master Code # 9 0 #

Mini Controller: Remove the back cover, and press the button "Pair"

If pair successfully, there will be one beep from both the controller and the keypad; if not, there will be three short beeps, then please repeat the setting. The keypad does not need to be entered * for exit in this step.

To pair the Wireless Exit Button and Mini Controller:

Wireless Exit Button: Remove the back cover, and press the button "Pair"

Mini Controller: Remove the back cover, and press the button "Pair"

If pair successfully, there will be one beep from both the controller and the exit button; if not, there will be three short beeps, then please repeat the setting.

Pair two pcs of Wireless Keypad and Mini Controller---Optional

(This is optional solution for users, the extra wireless keypad Does Not included in the packing list)

Wireless Keypad 1: * Master Code # 9 0 #

Wireless Keypad 2: * Master Code # 9 0 #

Mini Controller: Remove the back cover, and press the button "Pair"

If pair successfully, there will be one beep from both the controller and the keypads; if not, there will be three short beeps, then please repeat the setting. The keypads does not need to be entered * for exit in this step.

Reset to Factory Default

Open the back cover of the wireless keypad, press the button "RST" on the main board, hold it for 5 seconds, release it until hear a long beep, means reset to factory default successfully.

After that, all settings except the relay time will be back to factory defaults, **the users' information will still be retained.**

At the meanwhile, please pair the wireless keypad and wireless exit button with the mini controller again.

Low Battery Reminding

. With 3 pieces 3A(AAA) battery, the wireless keypad can work continuously for at least 1 year, basing 30 times PIN/card input a day.

If low battery of the wireless keypad, there will be 3 beeps when every key is pressed, and the LED will stay in Orange, then please replace the batteries within one week.

. With 2023 lithium battery, the wireless exit button can work continuously for at least 1 year, basing 30 times press a day.

If low battery of the wireless exit button, the LED will shine from Red to Green twice, please replace the battery within one week.

FCC STATEMENT :

This device complies with Part 15 of the FCC Rules. Operation is subject to the following two conditions:

- (1) This device may not cause harmful interference, and
- (2) This device must accept any interference received, including interference that may cause undesired operation.

Warning: Changes or modifications not expressly approved by the party responsible for compliance could void the user's authority to operate the equipment.

NOTE: This equipment has been tested and found to comply with the limits for a Class B digital device, pursuant to Part 15 of the FCC Rules. These limits are designed to provide reasonable protection against harmful interference in a residential installation. This equipment generates uses and can radiate radio frequency energy and, if not installed and used in accordance with the instructions, may cause harmful interference to radio communications. However, there is no guarantee that interference will not occur in a particular installation. If this equipment does cause harmful interference to radio or television reception, which can be determined by turning the equipment off and on, the user is encouraged to try to correct the interference by one or more of the following measures:

Reorient or relocate the receiving antenna.

Increase the separation between the equipment and receiver.

Connect the equipment into an outlet on a circuit different from that to which the receiver is connected.

Consult the dealer or an experienced radio/TV technician for help.

SK3- II - Simplified Instruction	
Function description	Operation
Enter the Program Mode	* (123456) # then you can do the programming (123456 is the factory default master code)
Change the Master Code	0 (New Code) # (Repeat the New Code) # (Code: 6 digits)
Add PIN User	1 (User ID) # (PIN) # (Repeat PIN) #
Add Card User	1 (Read Card)

Delete User	2 (User ID) # 2 (Read Card)
Exit from the Program Mode	*
How to release the door	
PIN Access	PIN #
Card Access	# (Read Card)
PIN + Card Access	# (Read Card) (PIN) #
<i>Note: there is a battery spacer inside the Wireless Exit Button, please take it off before operation.</i>	